



RUNFUN  
润峰复材

FRP



- ☑ Since 2004
- ☑ Cooperate with 7 of China top ten steel structure companies for skylights
- ☑ Two workshop equipped with 7 sets production lines, in both South of China and & north of China



- ✓ Worldwide top-5 manufacture made **fiberglass** (Taishan Fiber)
- ✓ **Imported film** USA brand DUPONT
- ✓ Supper wide production line, width up to 2650mm
- ✓ Imported **polyester resin** (USA Brand ASHLAND & DSM & SKD)



USA



Netherlands



USA





泰山玻璃纤维有限公司  
Taishan Fiberglass Inc.

China

# RUNFENG

## *Main product*

-  **Skylight sheets** for PEB steel structure buildings
-  **FRP Sandwich panels** for transportation tools, cold chain cabinet
-  **Plastic Cover** for greenhouse, house garage, poultry farm



2020

## Skylight sheets for PEB steel structure buildings

### *Let the sunshine in*

- ❖ Daylighting for Health and Well Being
- ❖ Daylight is full-spectrum, natural light that enables our natural circadian rhythms. Studies show that learning, working and shopping under daylight promotes occupant well-being.

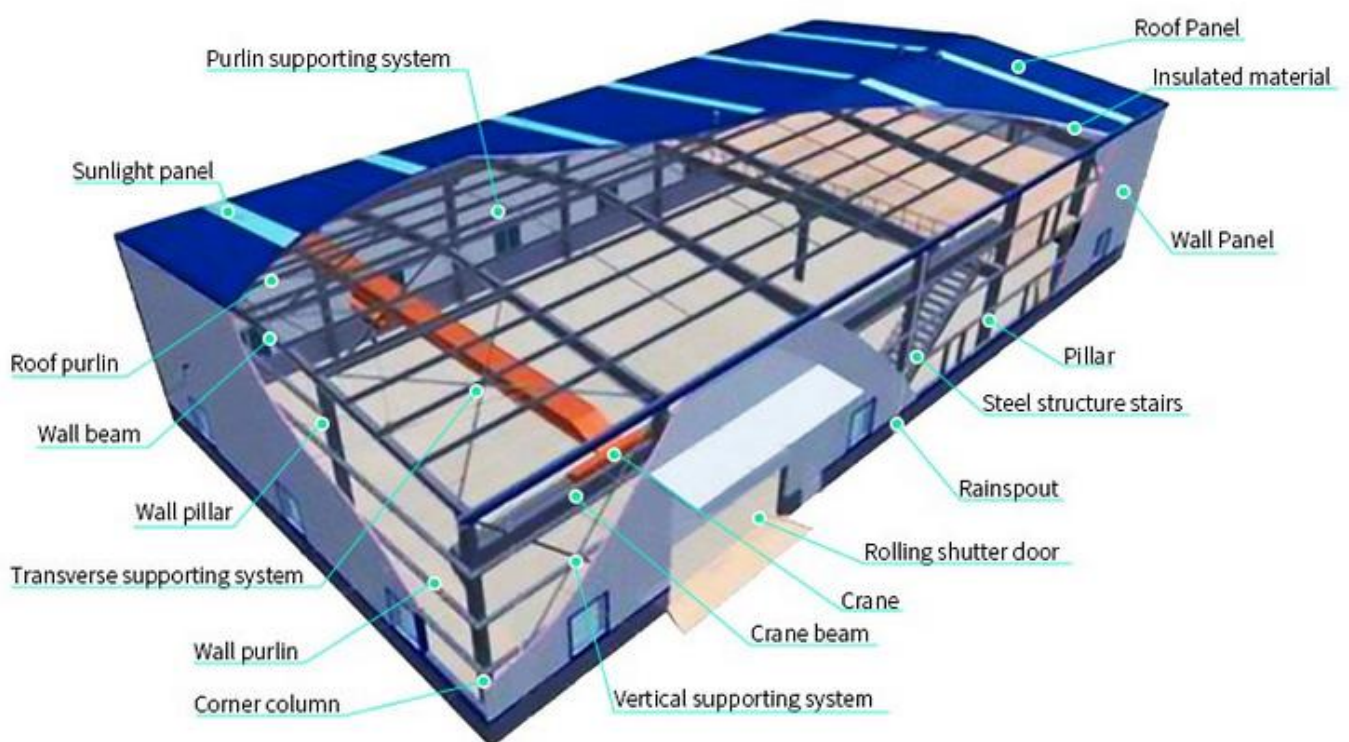

#### **Advantage :**

- Widely application, can be designed and used in concrete roofing, PEB roofing, steel structure roofing.
- Professional rain dropping structure, avoid water leakage.
- Aluminium edge with coated surface, beautiful and durable.
- Skylight sheets material : **FRP sheets**, PC sheets, glass.
- Light weight, durable with service life time at least 15 years.
- Lower coefficient of thermal expansion, similar steel plate. It can be applied in big area.
- Double layers FRP sheets are available, good heat insulation.

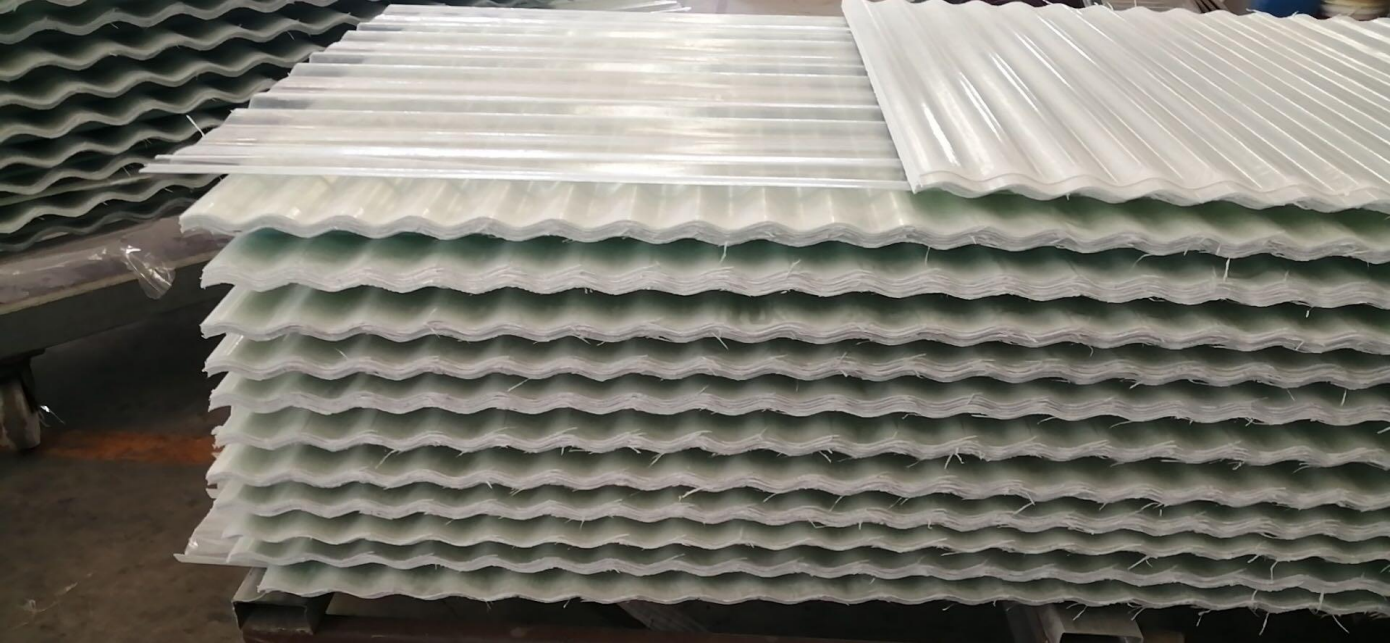
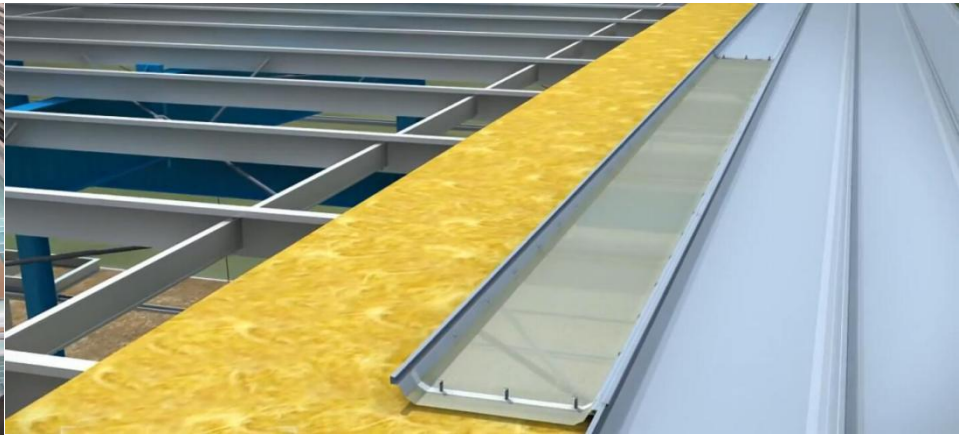

# Special application - data sheet:

**Endurable** FRP sheets used in industry area, High UV exposure area, usage life up to 25 years

**Fire-proof** FRP sheet used in hot rolling mill plant, etc

**Anti-corrosion** FRP sheet use in rolling mill, water treatment plant, etc.

## Features of FRP Flat Panel:

Type Features	Standard	High weatherability	Scattered Anti-Glare	Anti- corrosion	Secondary Fireproof	Glass A Fireproof	Heat Insulation	Gel coat
Skylight panel	√	√	√		√	√	√	
Standard thickness customized	1.2mm 1.5mm 2.0mm	1.5mm 2.0mm	1.5mm 2.0mm	2/2.5 mm 3/3.5mm 4.0mm	1.2mm 1.5mm 2.0mm	1.2mm 1.5mm 2.0mm	1.5mm 2.0mm	1.5mm ~ 4.0mm
Warranty ( years )	15	25	25	20	15	15	25	20
Surface treatment	Melinex® anti-aging film 3011	Melinex® anti-aging film 389	Melinex® anti-aging film 389	Melinex® anti-aging film 3011	Melinex® anti-aging film 3011	Melinex® anti-aging film 3011	Melinex® anti-aging film 389	Melinex® anti-aging film 3011
		200µm anti-UV Gel coat					200µm anti-UV Gel coat	200µm anti-UV Gel coat
Withstand temperture	-40~130°C	-60~130°C		-40~130°C	-40~130°C	-40~130°C		-40~130°C
Coefficient of thermal expansion	2.1X10 <sup>-5</sup> M/M/°C							
Ultraviolet light transmittance	≤0.01%	≤0.01%			≤0.01%	≤0.01%	≤0.01%	
Light transmittance ( thickness 1.5mm)	Transparent 85% Blue/green 75% white 65%				Transparent 85% Blue/green 73% white 65%		light blue/green > 70%	
Fiberglass content	≥30% ( ≥34% customized available)							
Resin SKD®	UP	iso-phthalic polyester resin	Runfeng patent - diffusivity 90%	Vinyl anticorrosive resin	fireproof resin	Reactive resin TM-108	Runfeng created	
Oxygen index					≥26	≥30		
Applications	warehouse	coastal areas & harsh environments	warehouse	Electroplating factory, foundry workshop, aluminum processing factory, breeding farm, that produce acid-base corrosion gas, etc.	Industrial plants, large warehouses, gas stations and steel plants  with flame retardant requirements		warehouse	truck freezer, refrigerated compartment, train compartment, boat, food processing workshop, pharmaceutical factory, hospital, toilet, etc.
	industry workshop		industry workshop					
	residence community		commercial building				commercial building	
	Supper -market	supper -market	supper- market					
	stadium	high ultraviolet radiation areas						

 **Plastic Cover** for greenhouse, house garage, poultry farm

**Greenhouse**



**House garage ( car-parking-shade)**



**Swimming pool**



**FRP (with gel coat) Sandwich panels** for transportation tools, cold chain cabinet

Dry freight (FRP/GRP with Plywood or Honeycomb core)

Refrigerated (temperature controlled) (FRP/GRP with PU ,EPS or XPScore)

FRP Sandwich Panels Core Type				
FRP XPS Panel	FRP PP Honeycomb Panel	FRP PU Foam Panel	FRP Plywood Panel	Customized Structure
				
Price: ★	Price: ★★ ★	Price: ★★	Price: ★★	Price: ★★ ★★
Insulation: ★★	Insulation: ★	Insulation: ★★ ★	Insulation: ★★	Insulation: ★★ ★★
Strength: ★★	Strength: ★★ ★	Strength: ★★	Strength: ★★ ★★	Strength: ★★ ★★



**Pebbled texture panel**

Thickness:1.2mm-3.0mm

Max width: 2750mm

Feature: anti-aging, good decorative surface, impact resistant.

Standard color: white creamy, Black



**Smooth panel**

Panel type: Gel coating flat panel & Non-gel coating flat panel

Thickness:1.2-3.0mm

Feature: anti-aging, smooth glossy surface.

Standard color: White Creamy Black



**FRP Leaf Texture Panel**

With 300µm gel coating on surface, anti-skid

Thickness:1.2-3.0mm

Standard color: White Grey Blue



# FRP Roofing profile samples

Model	width (mm)	profile
RF001-V840-210-25	1000	
RF002-V840-280-28	1000	
RF004A-V860-215-20	1000	
RF005-V820-205-28	1000	
RF010-V900-225-15	1000	
RF025-J760-380-71	1000	
RF026B-J820-410-50	1000	
RF027-J788-394-64	1000	
RF029-V475-355-80	670	
RF030-V865-173-15	1000	

# FRP Roofing profile samples

Model	width (mm)	profile
RF003-V850-212.5-25	1000	
RF009-V880-131-33	1000	
RF012-V910-130-10	1000	
RF014-V950-237.5-35	1200	
RF016-V960-320-40	1200	
RF018-V980-245-30	1200	
RF019-V1025-205-25	1200	
RF033-J788-280-68	900	
RF256-970-320-40	1200	
RF266-V1050-262.5-15	1200	

# WHY choose FRP board

## FRP Board VS PC lightning board:

Lighting board Technology indicator	FRP lighting board	PC lighting board
Raw materials	IPA resin+E fiber glass	PC
Coefficient of thermal expansion	Relative displacement is small caused by temperature changes	Relative displacement is larger caused by temperature changes, so that it is easy to have deformation and leak water . PC board should be short and can only used in small span roof
Tensile strength	Higher tensile strength , resisting typhoons~ongly	Lower tensile strength and bad resisting typhoon
Surface hardness	It is made from Organic and inorganic materials,have higher surface hardness and resisting laceration .	The particularity and uniformity of PC molecular structure caused bad surface hardness and resisting laceration.It will be leak water when it is easy to be cracked
Thermal conductivity	0.158w / (m.k) Better than PC	0.1666w / (m.k)
Construction costs	Can used be on steel roof between large span purling because of higher tensile strength .	PC board has lower tensile strength and big coefficient of thermal expansion . so it must be enhanced by small purling , if it is used on large purling it will accumulate water and leak water later
Surface maintenance	Lower maintenance cost, longer cycle , easy to clean by water and rainwater	Loss of dust will be on surface of PC board caused by electrostatic adsorption , which can influence PC board

## Company Profile



RUNFENG composite materials Co.,LTD established in 2004. Our factory cover an area of 54000 m<sup>2</sup>. We introduce advanced FRP continuous molding production line. As one of the first and largest global manufacturer of FRP roof and wall paneling, we offer the industry's most innovative and resilient FRP product (fiberglass reinforced plastic wall and ceiling panels, dome and other handwork product) and service for building roof and wall system.

### 15 YEARS EXPERIENCE

we have continued to pioneer numerous patented technologies for industrial and commercial product applications. We can produce as your design. We have built a proven reputation for industry leadership by partnering with customers and suppliers to deliver advanced, industry-leading solutions.



Mob./Wechat/WhatsApp: +86-15930397073 [Sophia](#)  
[www.rffrpsheet.com](http://www.rffrpsheet.com) [sophia.shifei@gmail.com](mailto:sophia.shifei@gmail.com)



Website: [www.rffrpsheet.com](http://www.rffrpsheet.com)

**Hebei Tangshan ( City-center Export office)**

Email: [sophia.shifei@gmail.com](mailto:sophia.shifei@gmail.com)

WhatsApp/Wechat/Mob.: +86 1593037073

**Hebei Tangshan ( headquarters)**

Tel: +86-318-5658866

**Jiangsu Kunshan factory I**

Tel: +86-512-57982626

**Jiangsu Haian factory II**

Tel : +86 - 512 -57982929